

**Land - PUBLIC SYNOPSIS**

**MLS#:** 890873      **Status:** Current      **Kickout:** No  
**0 MAIN STREET** Eliot, ME 03903      **List Price:** \$ 125,000

**Directions:** GOING TOWARD KITTEERY, THE LOT IS LOCATED ON A ROW (ON THE RIGHT) OFF MAIN ST (ALSO KNOWN AS RT 103) JUST PAST THE INTERSECTION OF MAST COVE RD

**Dockominium:** N      **Assoc. Fee /Mo:**  
**Neigh'd/Assoc:**

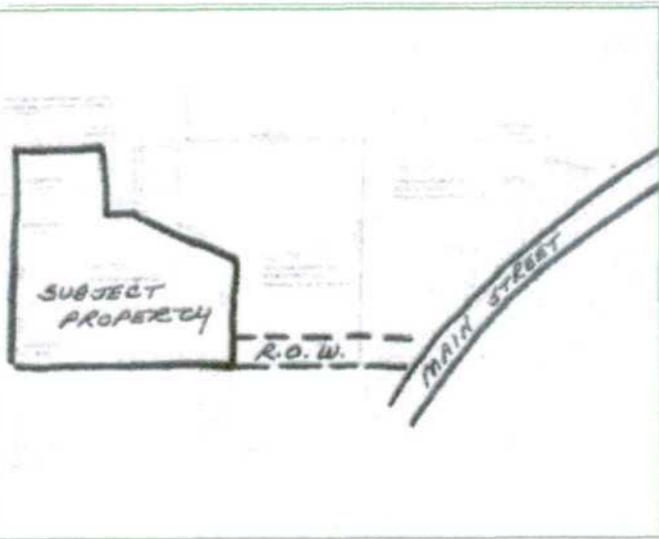

**General/Land Information**

<b>Lot Size (Acr)+/-:</b> 1.000	<b>Road Frontage+/-:</b>	<b>Surveyed/Seasonal:</b> Yes/No
<b>Flood Zone:</b> Unknown	<b>Water Body:</b>	<b>Zoning:</b> VILLAGE
<b>Amt Wtr Frntge+/-:</b>	<b>WF Owned/Shared+/-:</b> /	<b>WtrFrt:</b> No

**Remarks**

THIS IS A BACK LOT AND WILL ACCESS MAIN ST (RT 103) VIA A SHARED RIGHT-OF-WAY FROM MAIN STREET. THE UNDERGROUND NATURAL GAS LINE HAS A ROW & CROSSES ONE END OF THE PROPERTY.

**Property Features - NOTE: Check Detail Reports for complete list of Features.**

**Site:** Right of Way, Rolling/Sloping  
**Driveway:** No Driveway  
**Parking:**  
**Location:** Neighborhood  
**Uses:** Residential  
**Restrictions:**  
**Rec. Water:**  
**Roads:** Right Of Way  
**Transportation:**  
**Electric:** At Street  
**Gas:** No Gas  
**Sewer:** Septic Needed On Site  
**Water:** Public At Street

**Tax/Deed/Community Information**

<b>Book/Page/Partial:</b> 15089/224/	<b>Map/Block/Lot:</b> 14/51	<b>Tax Amount/Yr:</b> \$ 1,090 / (07-08)
<b>Tax Reduction:</b>	<b>School:</b> SAD 35	

**Off Market Information**

**Information Provided by: Nancy Shapleigh NES 002528**

<b>Office:</b> Nancy Boyce 1324	<b>Office:</b> 207-439-4909
<b>Agent Phone:</b> 207-439-4909	<b>Agent Cell:</b>
<b>Email:</b> NBOYCEREALTORS@AOL.COM	<b>Virtual Tour:</b>

**LAini:** NES      **List Office:** Nancy Boyce

